

Limelight[®] Collection

Owner's Manual Addendum



HotSpring[®]

Every day made better[®]

Congratulations on your decision to purchase a Hot Spring[®] Limelight[®] Collection spa. This addendum is provided as a supplement to the LIMELIGHT Collection Owner's Manual included with your hot tub. It is very important that you read the Owner's Manual.

YOUR LOGO LIGHT (on the front outside of the spa) BRIGHTNESS IS NOW ADJUSTABLE.

If you have any questions about the information contained in this addendum, please contact your local HOT SPRING dealer.

HOT SPRING LOGO LIGHT BRIGHTNESS ADJUSTMENT

1. Press OPTION hard button.
2. Press Set-Up soft button.



2

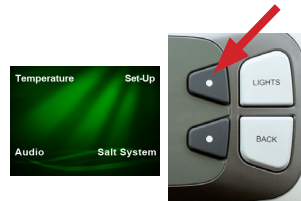

3

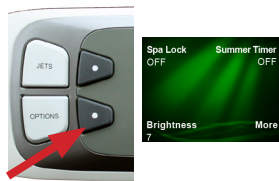

4



3. Press and hold Brightness soft button for **5 SECONDS** until Set Logo Light Brightness is visible.
4. Press Brightness soft button to change the logo light brightness. Press BACK hard button (lower right) to go back to brightness screen.